

TETON COUNTY, IDAHO



INTERNET MAPPING USER'S GUIDE

December 2010



Table of Contents

	Page
Interactive Map Overview	1
Searching Data	2
Search by Owner Name	8
Obtaining Property Information (Assessor's Database)	9
Property Addresses	10
Transportation	12
Public Land Survey System (Township, Range, Section)	14
Government Boundaries	
Legal Boundaries	15
Zoning	16
Public Lands	18
Wildlife and Habitat Layers	19
Water Resources	
Wetlands	20
Irrigation Companies	21
Measuring	
Linear Distance	22
Areas	23
Obtaining Position Coordinates	24
Fire Hydrants	25
Aerial Imagery	26
Elevation	
USGS Topographic Maps.	27
USGS Digital Elevation Model	28
Printing Maps	29
Plats/Surveys	30
FEMA Flood Insurance Maps	33
Downloading GIS Data	35
INSIDE Idaho and Other Resource Links	36

The “Interactive Maps” section, located on the GIS - MAPPING web page, has two options for viewing internet data. Click on the “Public GIS Map” link, this takes you to Teton County’s Web Mapping Application. Note: the application will time out after 10 minutes of inactivity and will need to be restarted.

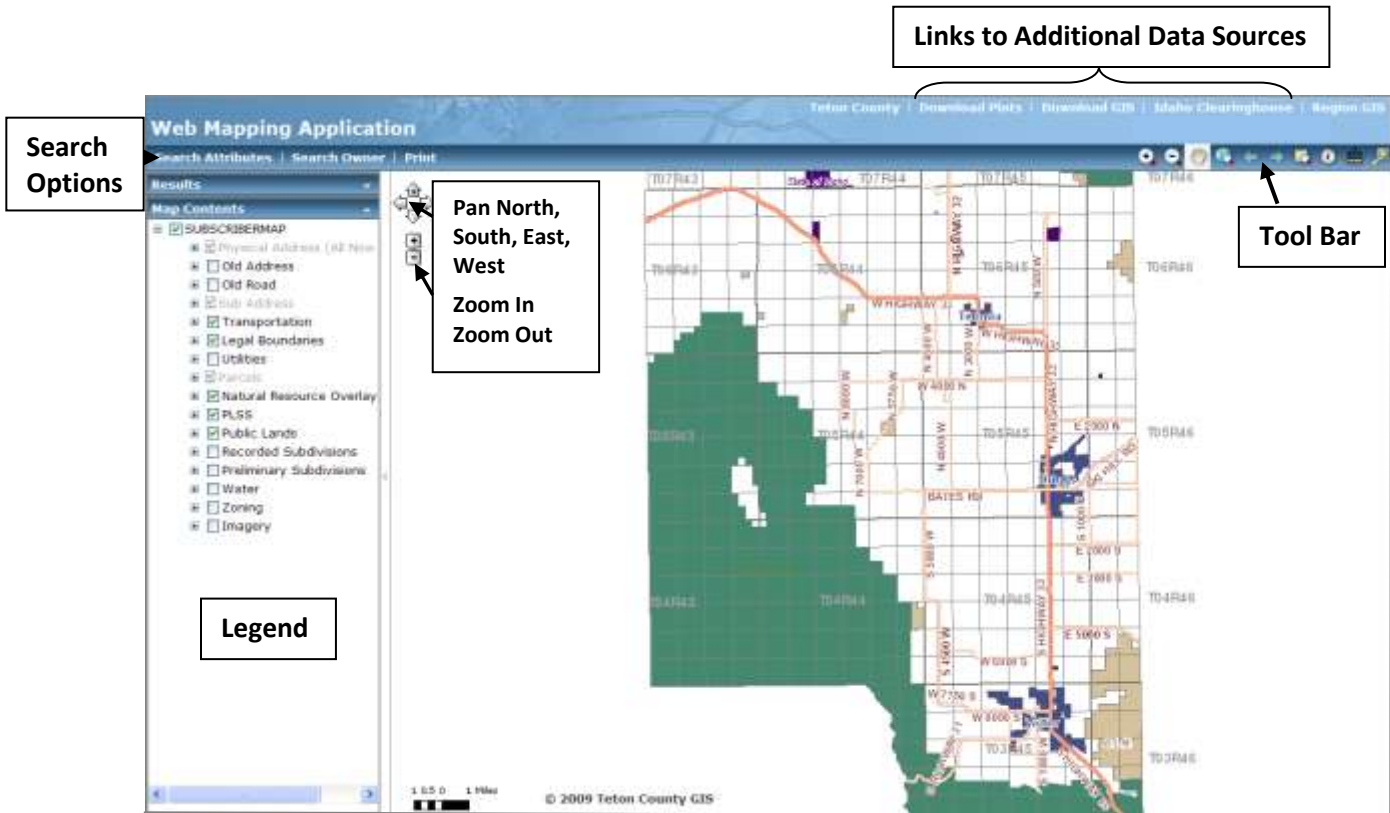

There is a set of tools located in the upper right corner of the map. These tools are used to navigate the map:

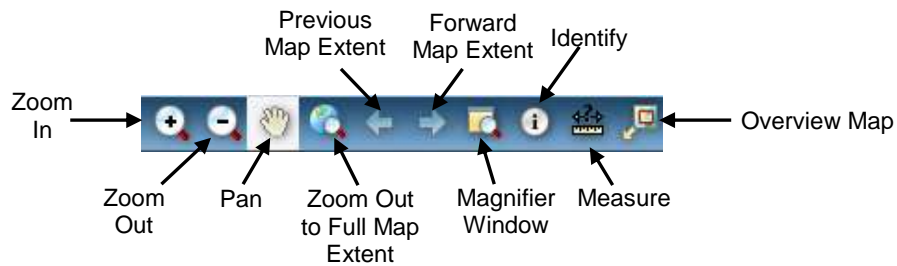

The legend resides to the left of the map. It displays the various data sets that can be viewed. The check boxes next to the data labels are used to control which data sets are visible. Click in the check box to turn a data layer on or off. Note that the layers are scale-specific. This means that some of the layers will not be visible unless the map has been zoomed in sufficiently.

Those entries that are grayed-out in the legend cannot be viewed until the map is zoomed in to the appropriate scale.

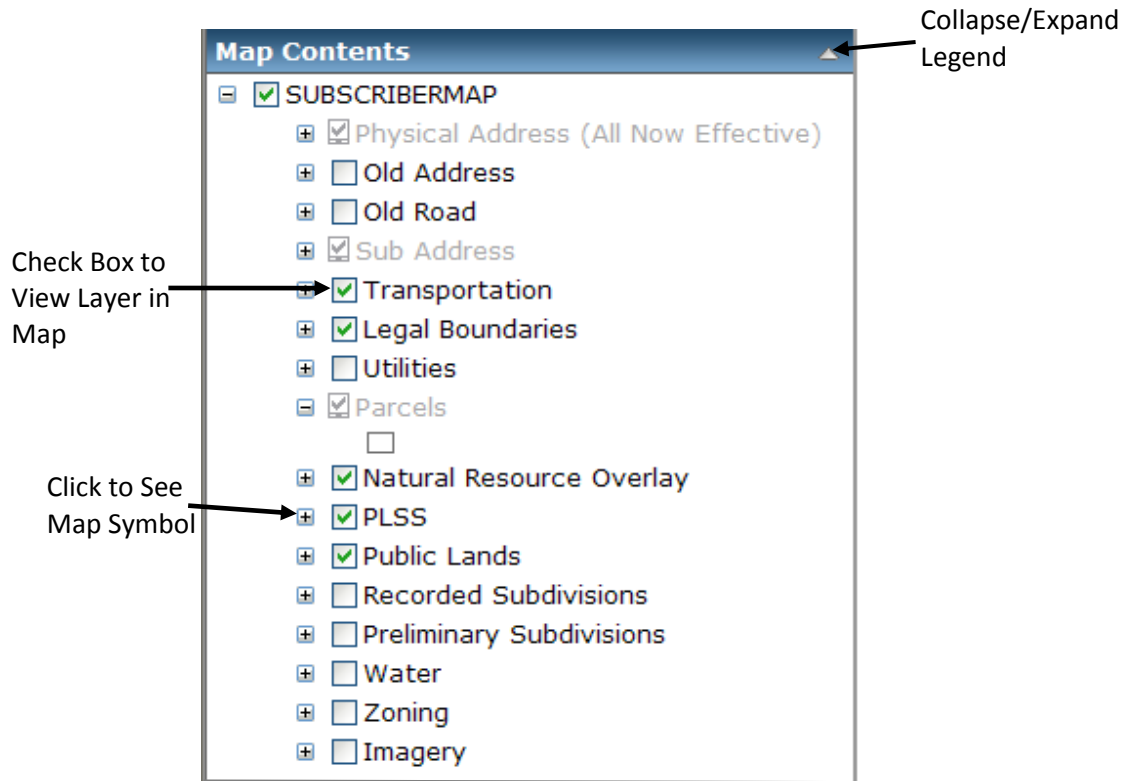

Searching Data

There are tools located above the legend to aid in acquiring information.

[Search Attributes](#) | [Search Owner](#) | [Print](#)

Click on the "Search Attributes" link. A dialog box appears.

The 'Search Attributes' dialog box has a title bar with a close button. It contains a text input field labeled 'Search for:' and a 'Find' button.

This tool will search on the following parameters:

- Current/Former Property Address
- Property Identification Number (PIN)
- Road Name
- Subdivision Name (preliminary and recorded)

Enter the search string in the text box and click the “Find” button.

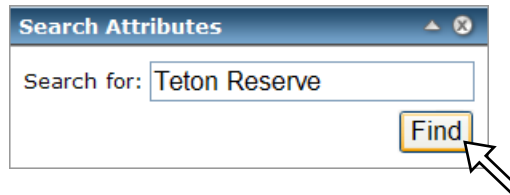

The results of the search appear in the “Results” section located above the legend. If the text entered in the search dialog box is contained in any part of a road name, subdivision name, parcel identification number, or address, the “Results” section will display the search results for each category.

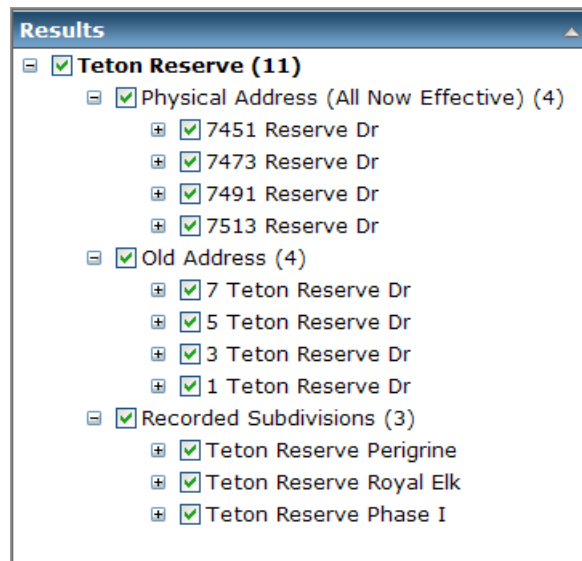

Click on the expand button  to view details of the search results.

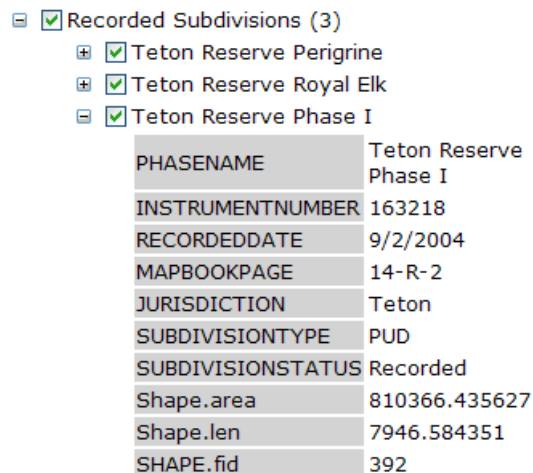

Right-click (click the “right” mouse button) on the desired result. A drop-down menu appears with the option to “Zoom To”, “Pan To”, or “Remove” the selection.

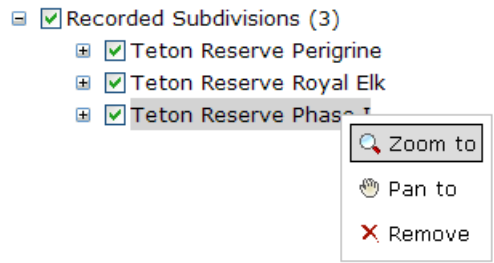

Right-clicking on the category label allows the entire selection to be zoomed to (or removed). Clicking on “Zoom To” or “Zoom To Selected Features” brings the map to the area of interest.

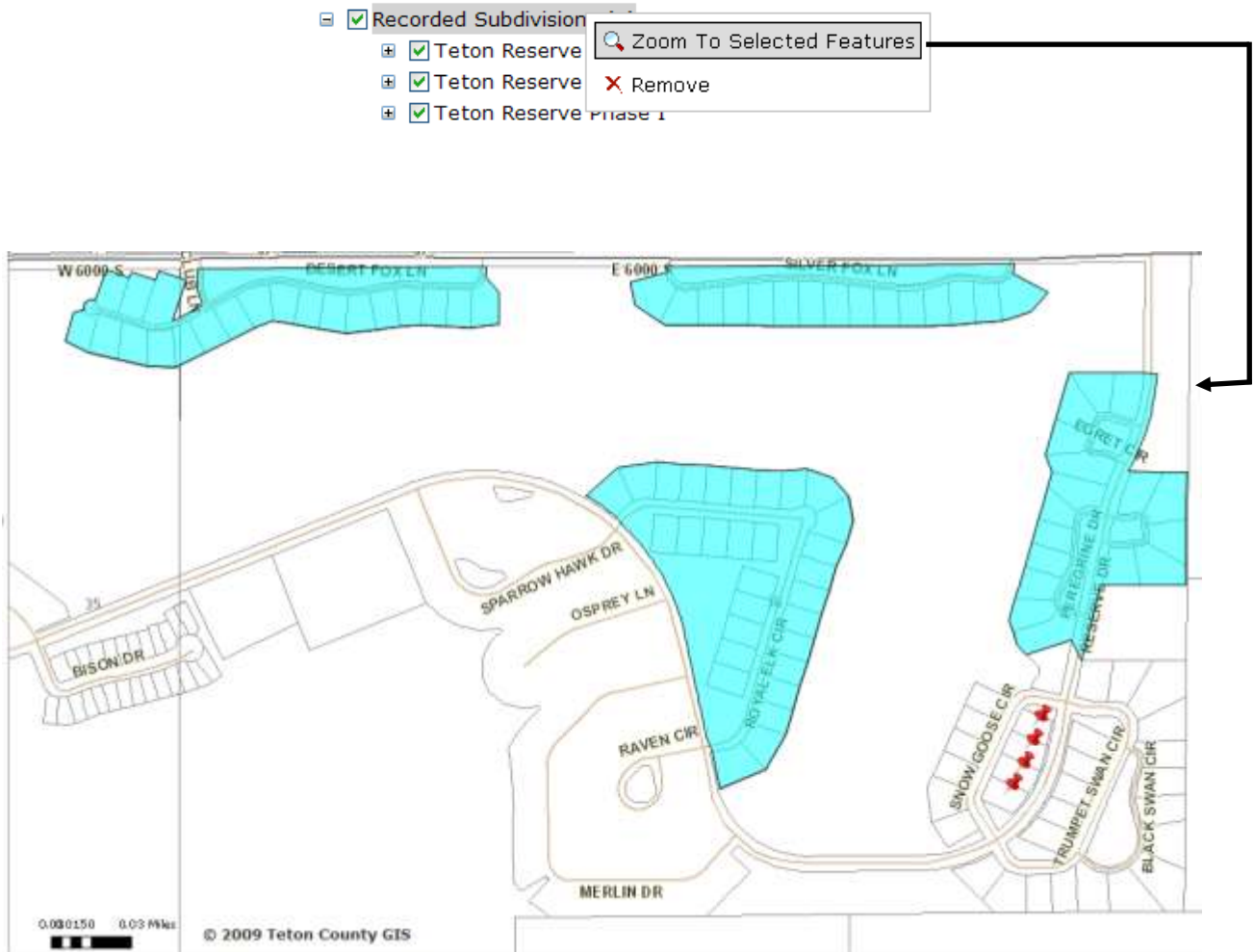

The search results appear in blue. Once the area of interest is in the field of view, place the cursor over one of the entries in the “Results” section. This highlights the selected area in pink.

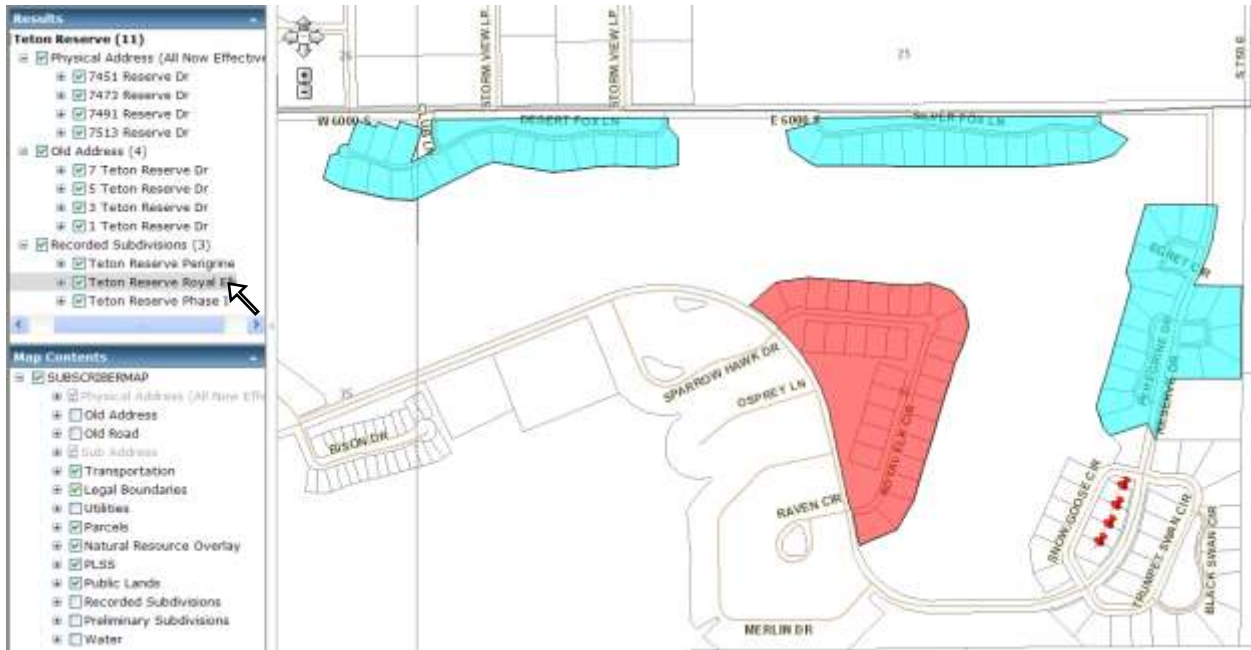

Zoom in further using the  tool on the tool bar to view parcel numbers, addresses, and property owners.

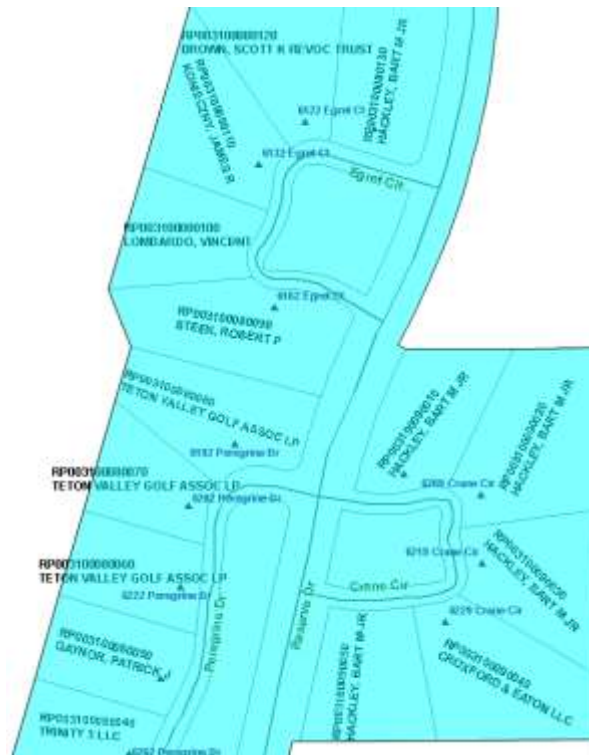

Land information can also be searched using the parcel identification number (PIN). Enter the 14-digit parcel number (or any part of the number) and click the “Find” button. (Note, the PIN is NOT case-sensitive.)

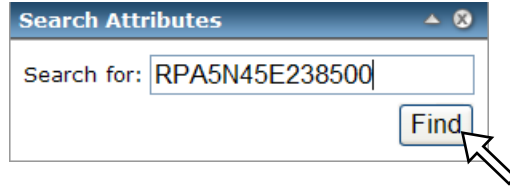

Right-click on the search result and select “Zoom To”. The map zooms to the area of interest which appears in blue.

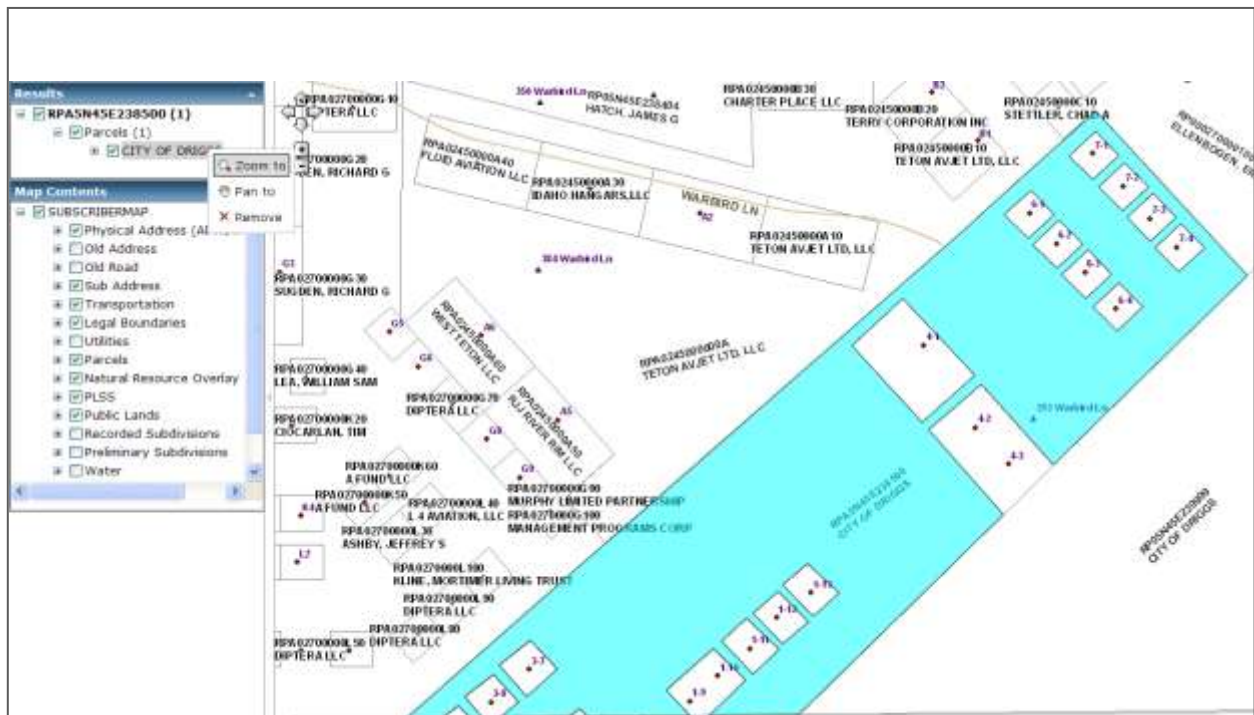

Search by Owner Name

The search section has a separate link to search on property owner name.

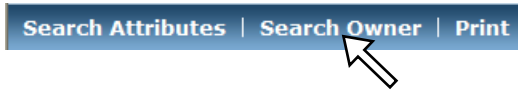

Enter any part of the property owner name and click "Find".

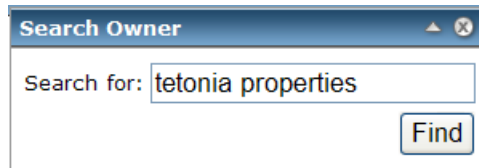

Right-click on the desired search result and click "Zoom to" or "Pan to" in order to bring the selected area into the map view.

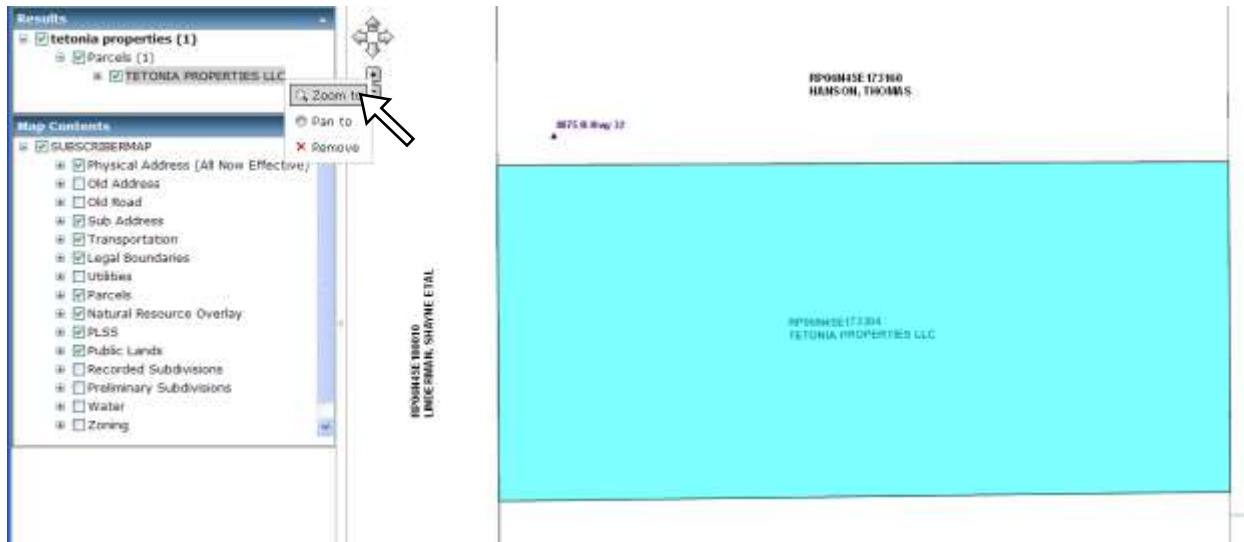

Obtaining Property Information

Parcel data is linked to the Assessor's database. To obtain tax codes, valuation, acreages, legal descriptions, property addresses, and owner information, click on the identify tool  and then click on a parcel. A box appears with the owner name and a pull-down menu. Click on the down arrow to expand the box.



The box expands to provide information about the parcel including ownership, subdivision, parcel identification number, lot number, and physical and mailing addresses.

CITY OF DRIGGS (Parcels)	
OBJECTID	12031
PIN	RPA00000352472
Owner	CITY OF DRIGGS
Mailing_Address	PO BOX 48
Mailing_Continued	
Mailing_City	DRIGGS
Mailing_State	ID
Mailing_Zip	83422
Physical_Address	
Categories	81
Legal_1	TAX #3621
Legal_2	SEC 35 T5N R45E
Legal_3	
Legal_4	
Legal_5	
Legal_6	
Total_Value	0
Improved_Value	0
Land_Value	0
Tax_Code_Area	10001
Shape.area	15013.452351
Shape.len	492.237761
SUBSCRIBERMAP > Parcels	
Add to Results	

Property Addresses

Teton County initiated a county-wide readdressing effort in 2008 that became effective on March 15, 2009. Current and former addresses can be obtained from the online map. In the legend, click the check boxes for “Physical Address” and “Old Address”.

- Physical Address (All Now Effective)
- Old Address

Zoom to the area of interest until the address points appear. New addresses are labeled in purple, and the previous addresses are labeled in red.

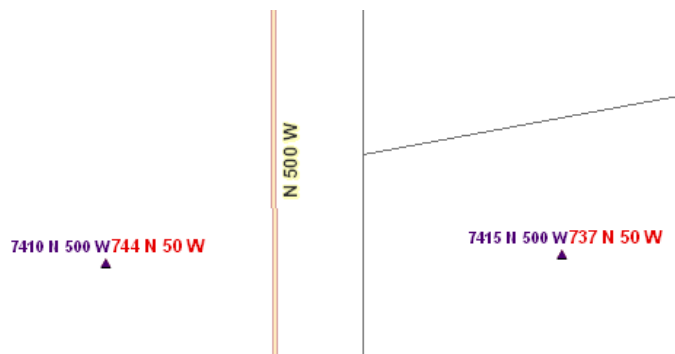

Address change information is also available by selecting the identify tool  and clicking on the “Physical Address” symbol. The current address (LABELNAME field) and previous address (OLDADDRESS field) appear in the information box.

7455 N 500 W (Physical Address (All Now Effective))

HOUSENUMBER	7455
LABELNAME	7455 N 500 W ← Current Address
ADDRESSJURISDICTION	Teton
Community/ zip code	Tetonia
OLDADDRESS	743 N 50 W ← Previous Address
ZIPCODE	83452
SITE_STATUS	Occupied

SUBSCRIBERMAP > Physical Address (All Now Effective)
[Add to Results](#)

7455 N 500 W 

Multi-Unit Buildings and Sub-Addresses

For parcels containing multiple domiciles or businesses, such as condominiums or townhomes, sub-addresses are assigned to the individual units. These can be viewed by activating the “Sub Address” category in the legend.

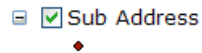

When an area is zoomed in sufficiently, points labeled with the unit designations appear. Points oriented close together indicate the units are stacked within a multi-story building. A complete address can be determined by activating both the “Physical Address” and “Sub Address” categories in the legend.



Unit Designations

Primary Address

Transportation

Under the “Transportation” category in the legend are various subcategories that come into view when the map is sufficiently zoomed in. At full extent, major roads are visible. Zooming in to the map further allows county and non-county roads to be viewed.

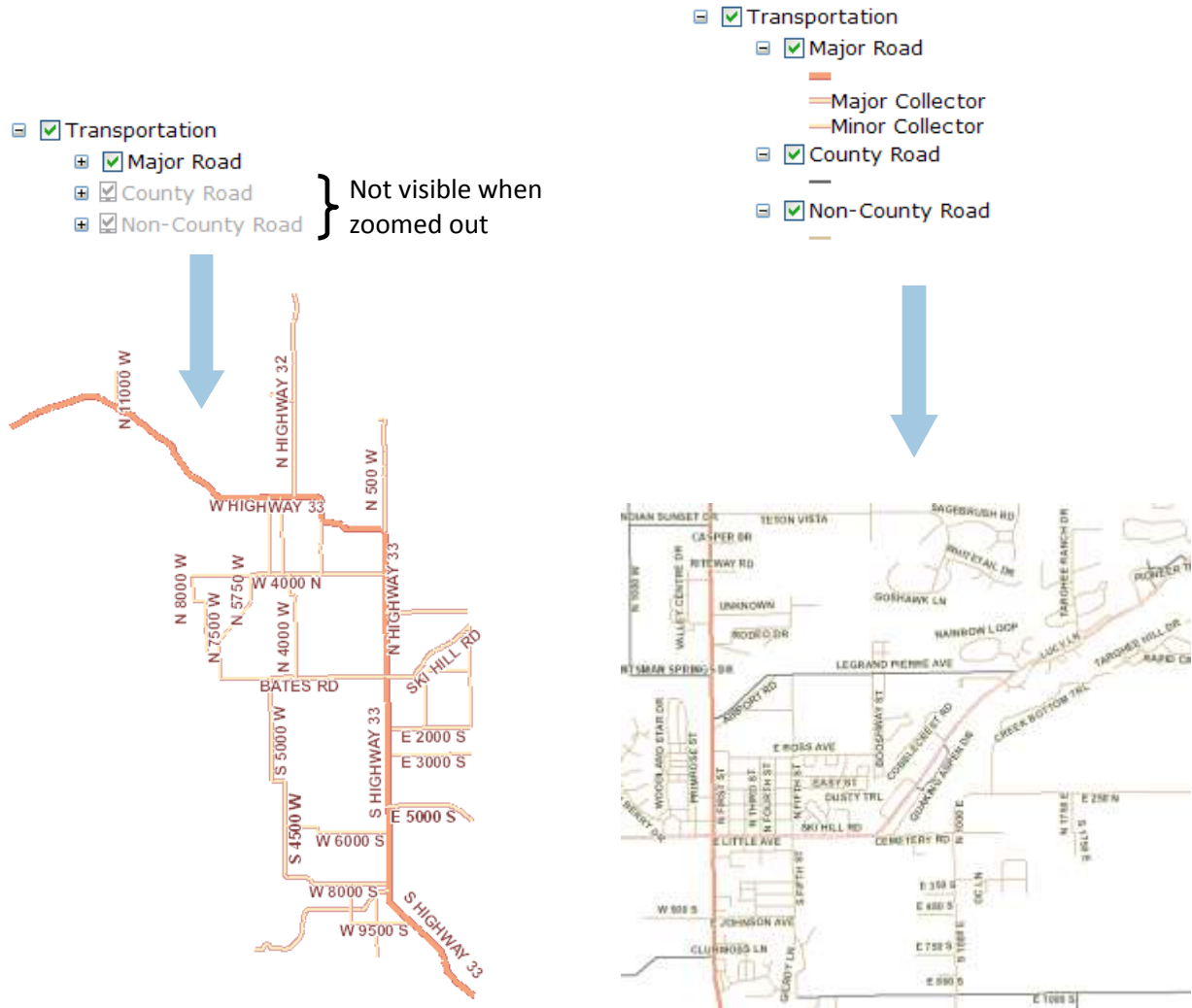

The *Idaho Transportation Department* assigned various attributes to classify each road in the county. Click in the check box next to the “ITD Classifications” subcategory under “Transportation” to view state road department information.

- ITD Classifications
 - Major Arterial
 - Minor Arterial
 - Principle Arterial
 - Major Collector
 - Minor Collector
 - Major Neighborhood
 - Minor Neighborhood

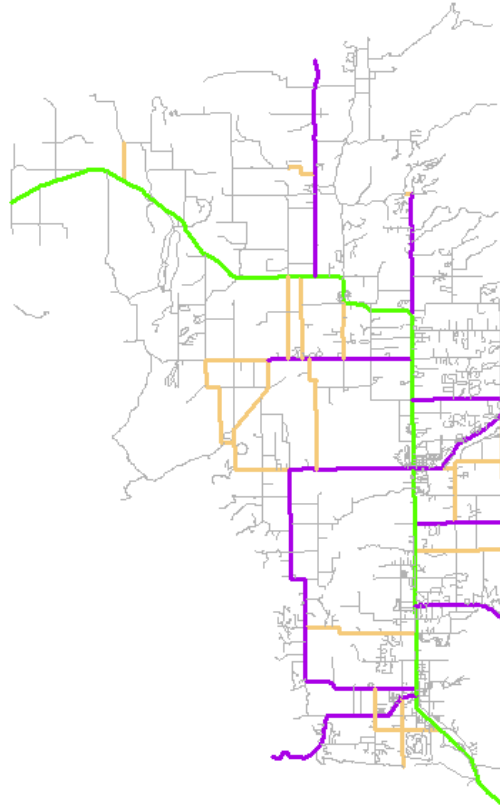

Activate the identify button  on the toolbar and then click on a road line. A dialog box containing the various road attributes appears for the selected road segment.

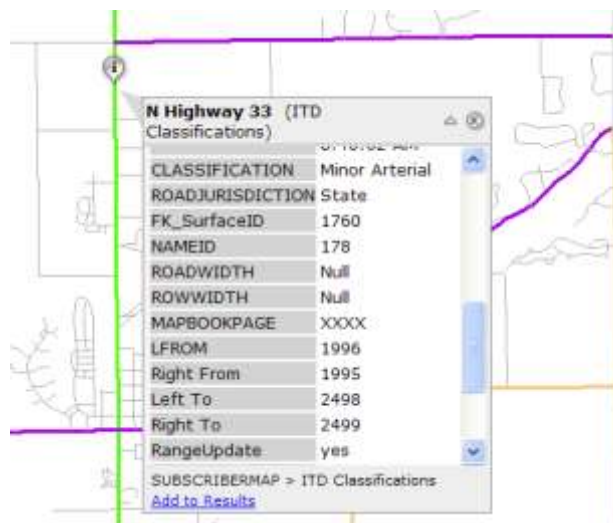

Public Land Survey System

Land within the United States is subdivided by a rectangular grid system called the “Public Land Survey System” (PLSS) consisting of Township, Range, and Section. Surveyors use this system to describe the location of an area. This description appears on recorded plats. When the internet map is initially started, the grid appears. The box next to “PLSS” in the legend is checked by default.

- PLSS
 - Sections
 -
 - Mask
 - Township
 -

Expanding the “PLSS” category in the legend shows three layers. “Township” (which also contains the Range identifier) and “Sections” layers define the PLSS. The “Mask” layer crops the map to the county boundary. An area can be located from its legal description based on the PLSS. Note, for Teton County, Idaho, all Townships are north and all Ranges are east of a referenced origin.

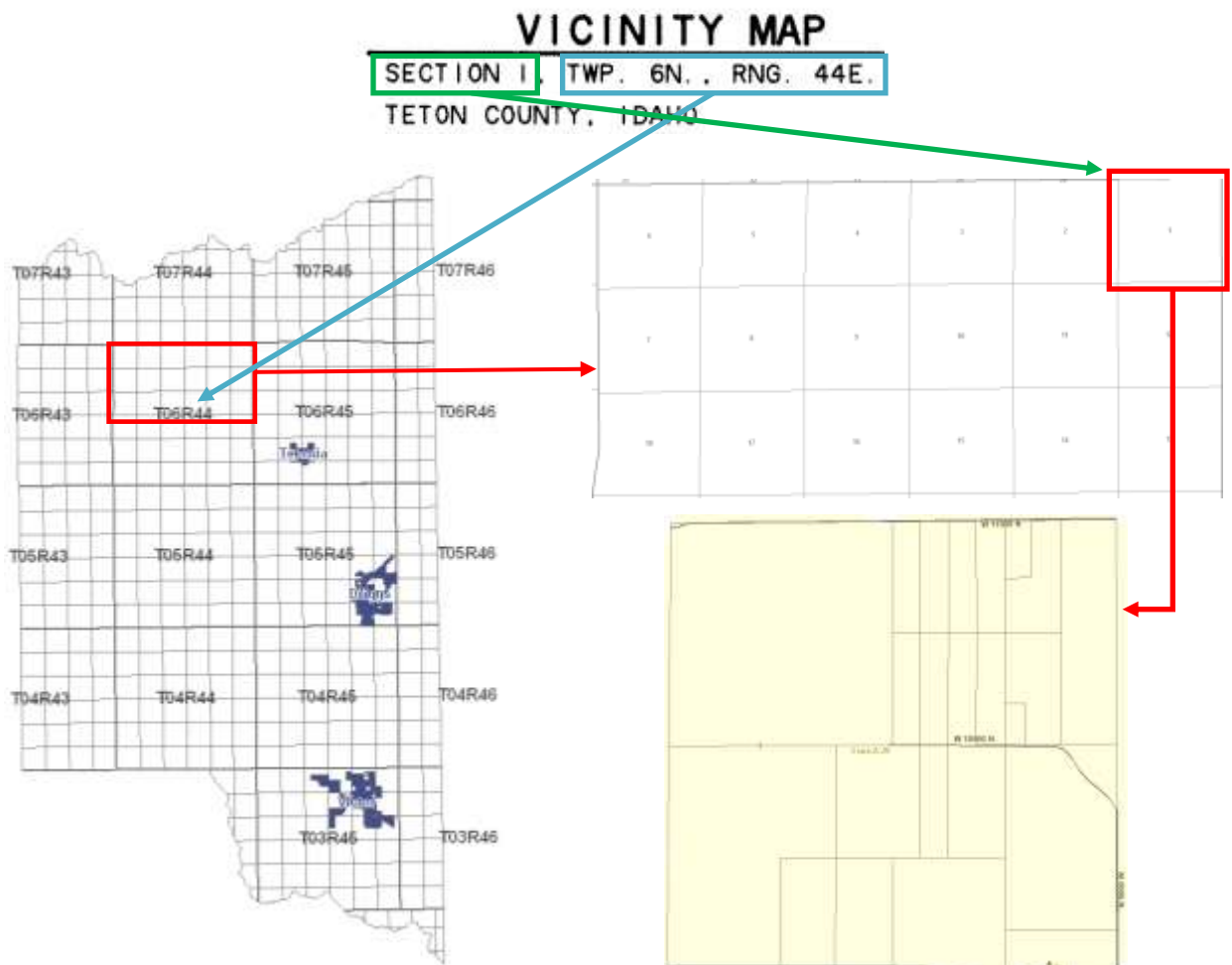

Government Boundaries

The internet map can display various government boundaries. Under the “Legal Boundaries” category in the legend, click the expand button to see the subcategories of voter precincts, tax code areas, town boundaries (Jurisdiction), and zip code boundaries.

- Legal Boundaries
 - Voter Precincts
 - Precinct 1
 - Precinct 2
 - Precinct 3
 - Precinct 4
 - 2009 Tax Code Areas
 - 0010000
 - 0010001
 - 0020000
 - 0030000
 - 0040000
 - 0050000
 - 0060000
 - 0070000
 - 0080000
 - 0090000
 - 0100000
 - 0110000
 - 0120000
 - 0130000
 - 0140000
 - Jurisdiction Boundaries
 - Zip Code

View a layer by clicking in the check box next to the subcategory.



Voter Precincts

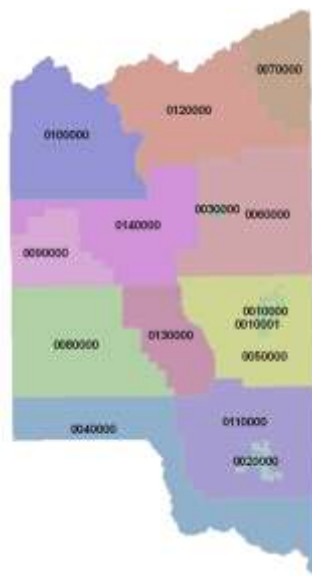

Tax Code Areas

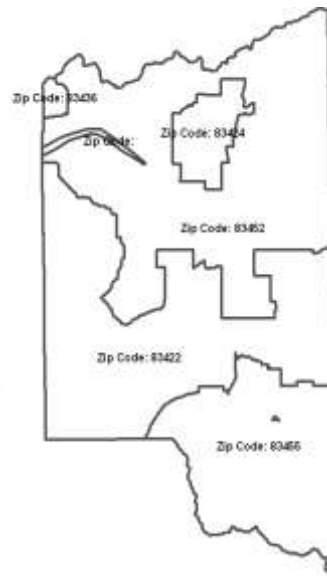

Zip Codes



Jurisdictional Boundaries

Those layers represented as solid polygons are set at 50% transparency, allowing multiple layers to be viewed at the same time. For example, voter precincts for an area or individual parcel can be determined by viewing the parcel and voter precinct layers together.

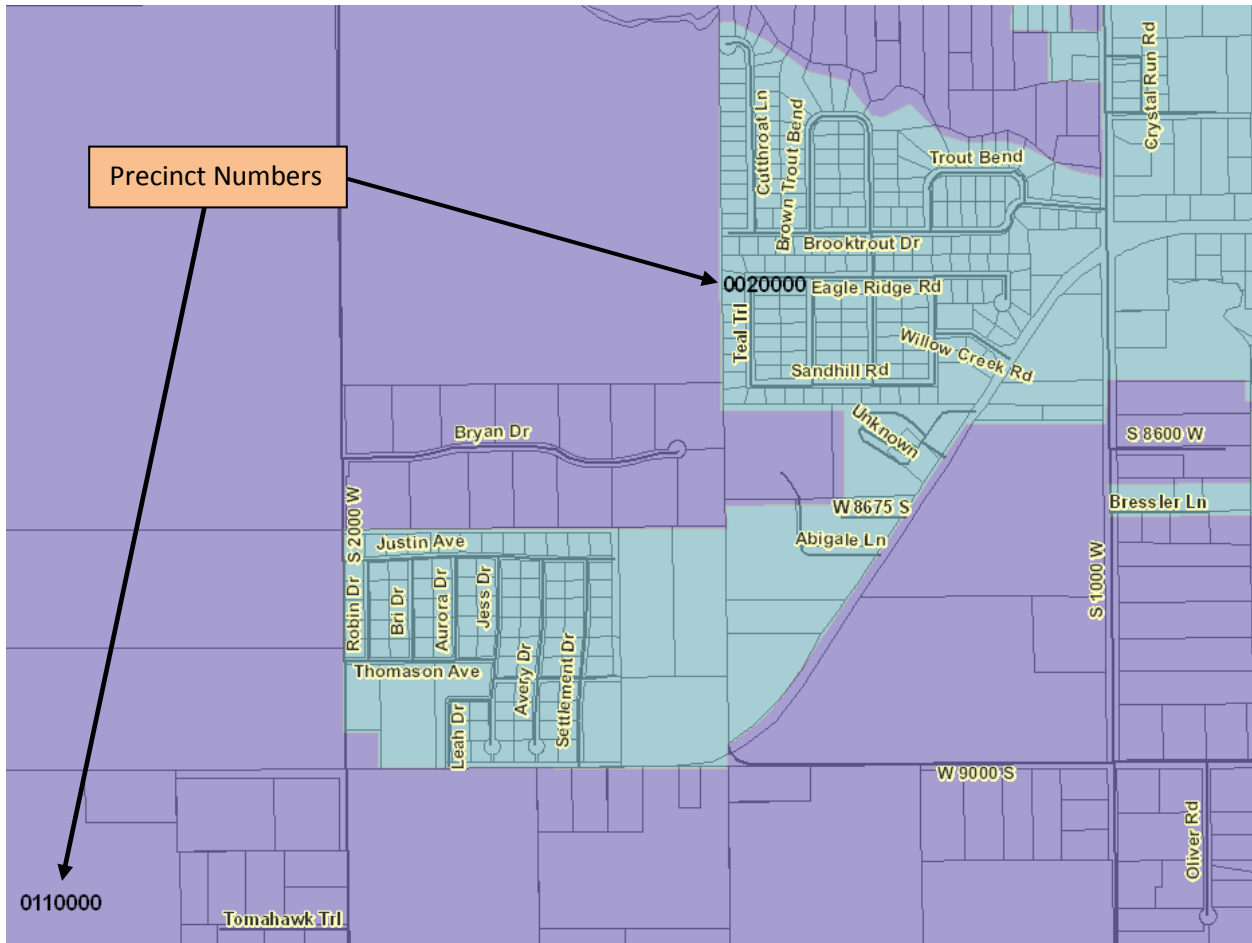

Zoning classifications can be viewed by clicking the “Zoning” check box in the legend. Expanding the “Zoning” category shows the color representations for the various classifications and impact areas.

- Zoning
 - A-20
 - A-2.5
 - Commercial
 - M-1
 - Public Lands
 - Impact Area
 - Tetonia Impact
 - Victor Impact

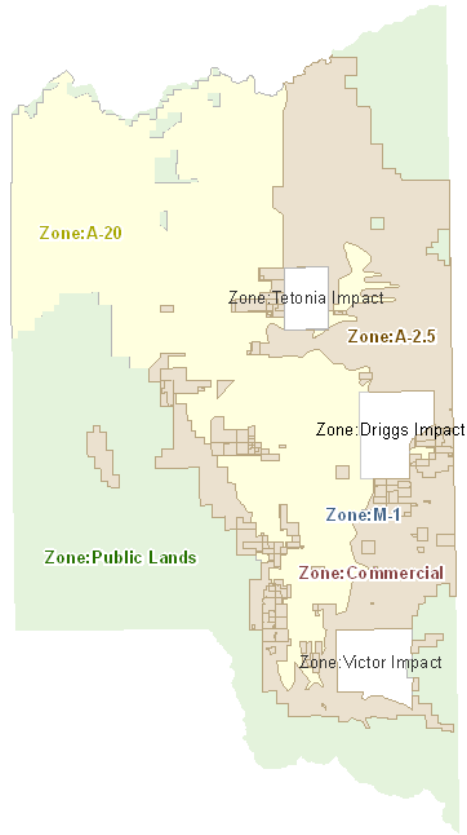

Zoning can be viewed in combination with other layers such as roads and parcels to determine zoning designation for a particular area.



Other boundary information includes public lands. Areas owned by the U.S. Forest Service, Bureau of Land Management, and the State of Idaho can be viewed under the “Public Lands” category.



Wildlife and Habitat Layers

There are several layers representing big game and bird habitats, breeding grounds, foraging and migration corridors, seasonal ranges, and priority wetland habitats. These data are provided by the Teton Regional Land Trust. These layers can be viewed by activating “Natural Resource Overlay” in the legend. Click on the expand button to see the various layers. Click in the check box(es) to view the layer(s) of interest in the map.

- Natural Resource Overlay
 - Priority Wetland Habitat
 - Priority Wetland Habitat
 - Priority Wetland Habitat-Woods Creek Fen
 - Priority Wetland Habitat - Woods Creek Fen
 - Priority Wetland Habitat-South Leigh
 - Priority Wetland Habitat - South Leigh
 - Big Game Migration Corridors
 - Big Game Migration Corridors and Seasonal Ranges
 - Raptor Breeding and Wintering Habitat
 - Raptor Breeding and Wintering Habitat
 - Songbird/Raptor Breeding Habitat
 - Songbird/Raptor Breeding and Wintering Habitat
 - Sharp-tailed Grouse Breeding Habitat
 - Columbian Sharp-Tailed Grouse Breeding Habitat
 - Waterbird Breeding, Migration, Foraging and Wintering Habitat
 - Waterbird Breeding, Migration, Foraging and Wintering Habitat

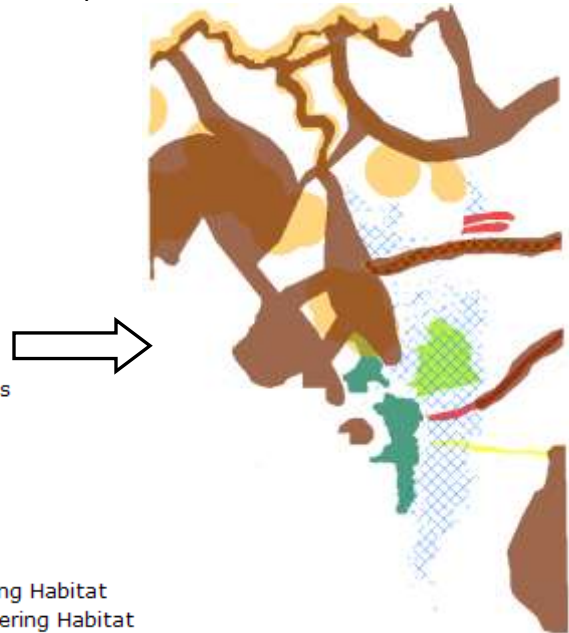

An overlay of these data sets with land ownership, roads, legal boundaries, etc., can be useful in determining impact on wildlife or protected habitats. The map below shows big game migration corridors and seasonal ranges and their proximity to roads and municipal boundaries.



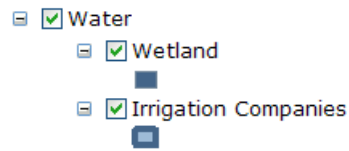

Water Resources

Under the “Water” category in the legend are two subcategories titled “Wetland” and “Irrigation Companies”.

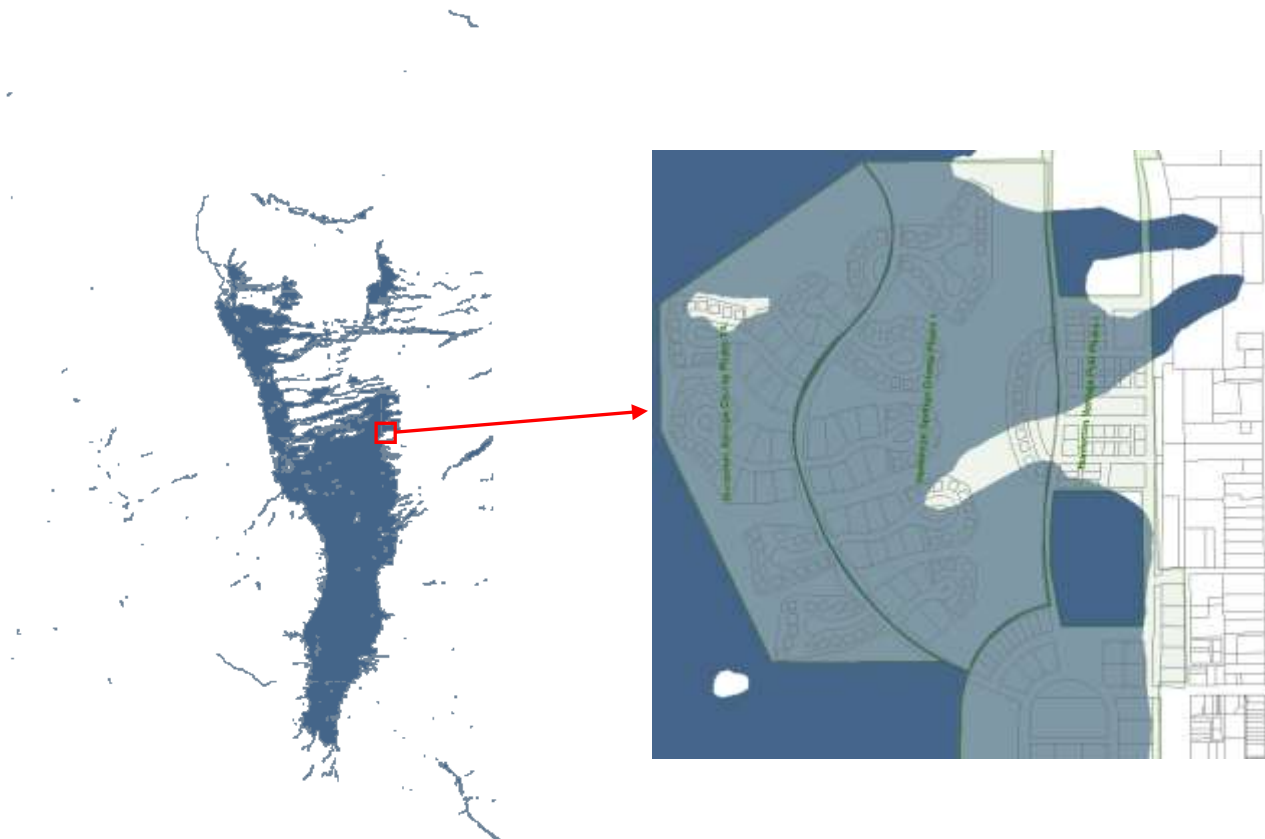

The wetland data was provided by the *Idaho Department of Water Resources (IDWR)* and displays wetland boundaries. This layer can be viewed in combination with other layers to determine proximity to wetlands.



The IDWR also provides locations of service areas in which an irrigation company can deliver its water rights. Activate the “Irrigation Companies” layer in the legend. Zoom in to the area of interest. Activate the identify tool  and click within an irrigation company’s boundary. A box appears containing the company name, mailing address, telephone number, and person of contact. (**Note:** Other layers above the “Water” layer need to be unchecked in order to identify any feature from the “Irrigation Companies” layer.)

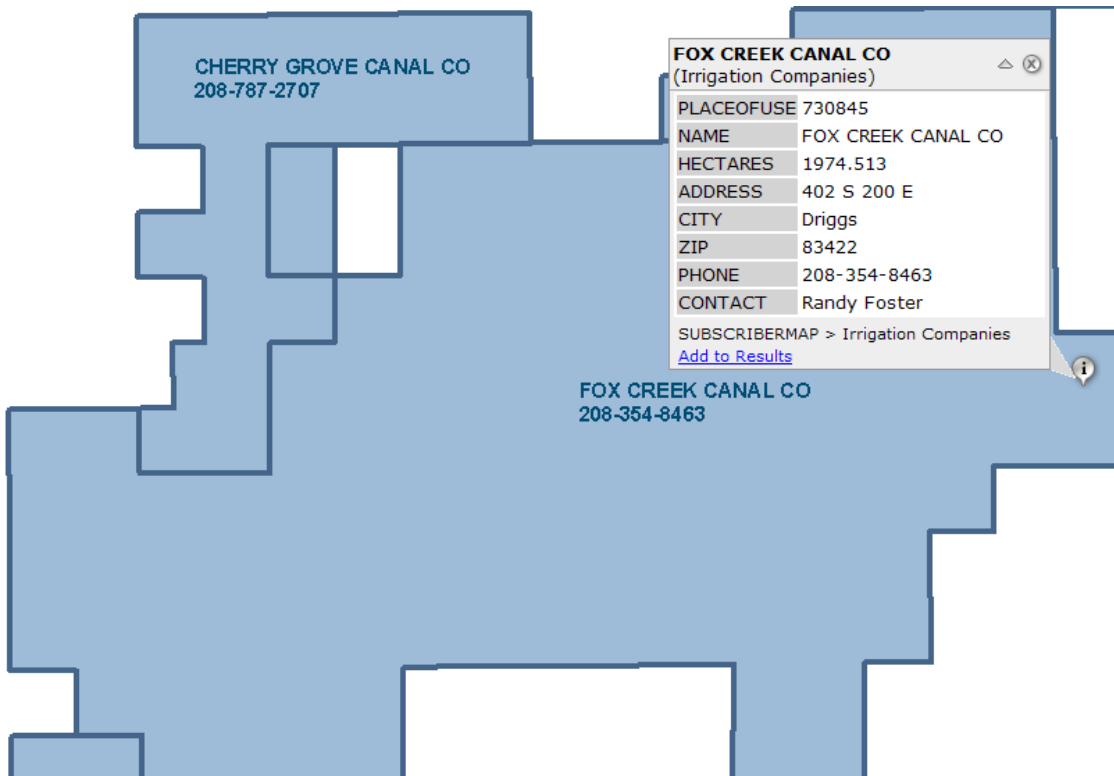

Measuring Areas and Distances

The online mapping system allows you to determine areas and linear distances, as well as determine X-Y coordinates for a point location. Click on the measure tool . A dialog box appears with the option to measure a distance or determine an area or point location.

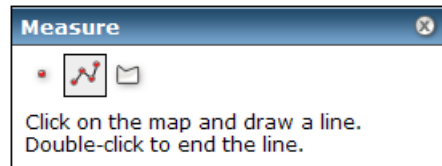

To measure linear distance, click at the starting point and drag the mouse to the destination point.

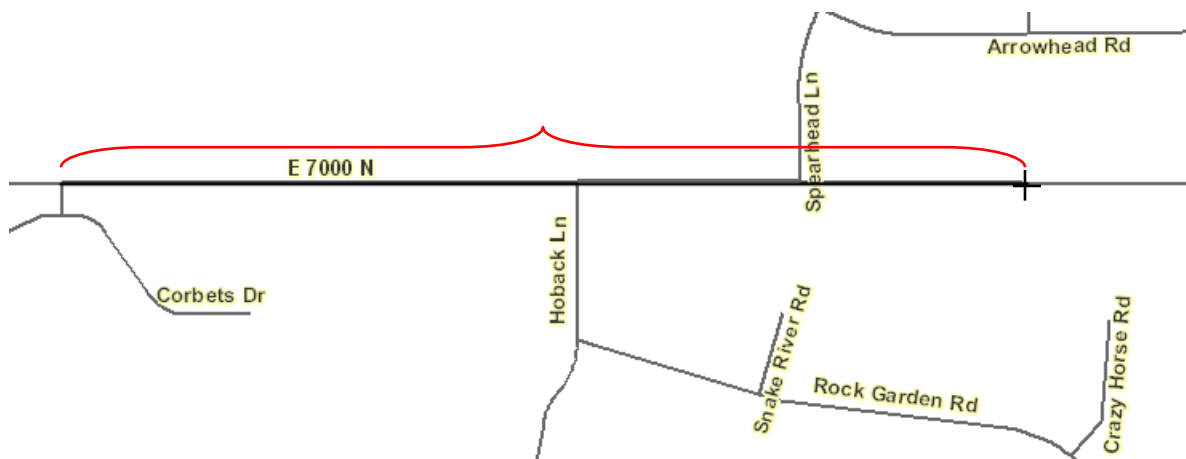

Double-click at the destination point, and the dialog box displays the measured distance. The pull-down menu allows you to change the units of measure. The distance is recomputed to the new units.

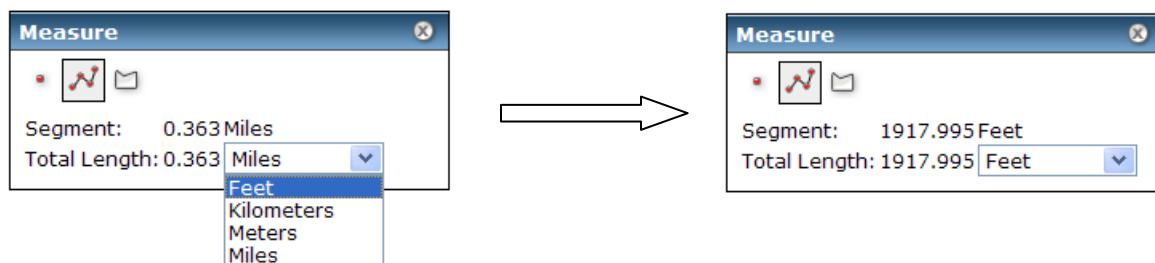

For distances that are defined by curved lines or change direction, click once at the end of each line segment. Double-click when the destination is reached to get the total distance.

To measure an area, click on the polygon symbol in the dialog box.

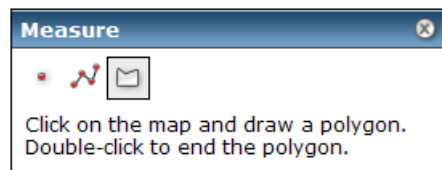

Trace out the area you wish to measure. Click once at each corner. Click several times around a curve to best approximate a curved boundary. Double click when tracing has been completed. The dialog box provides the area and perimeter measurements of the drawn polygon.

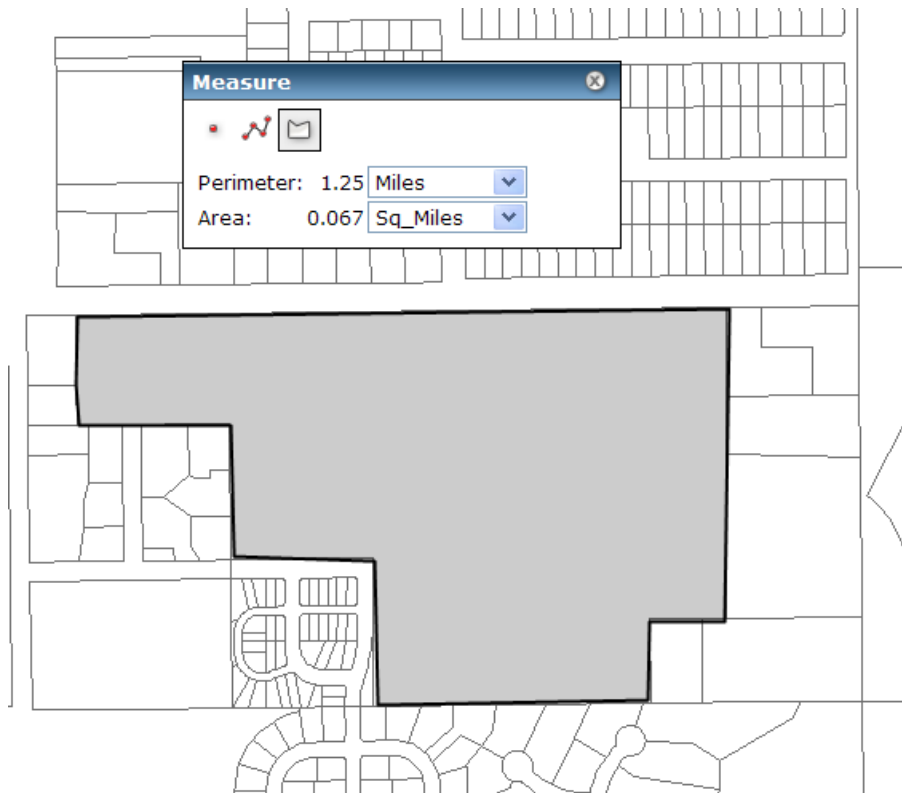

The units of measure can be interactively changed for both the Perimeter and Area. Click the arrow next to the units. A drop-down menu appears, allowing you to select the units. Linear units are *miles*, *kilometers*, *feet*, and *meters*. Area measurements are in *acres*, km^2 , m^2 , ft^2 , and $miles^2$.

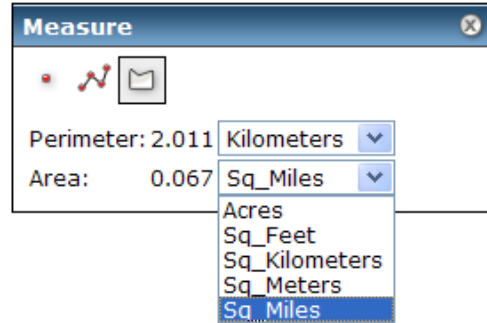
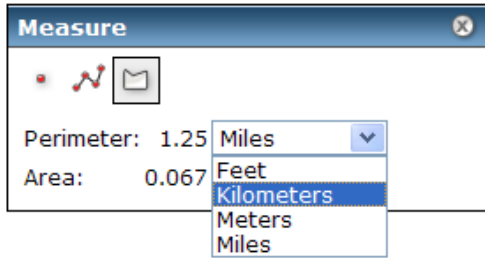

Obtaining Position Coordinates

The measure tool can also be used to determine coordinates for a single point. Click on the point symbol, and then click on a single location in the map.

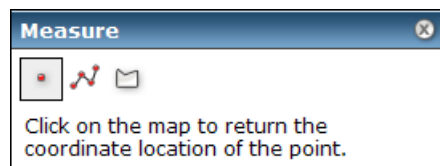

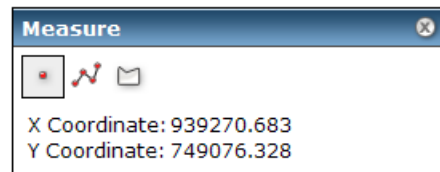

The dialog box returns the X-Y coordinates for the location. The coordinates are in “feet” and are based on the “State Plane – Idaho East” coordinate system.

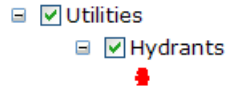

Fire Hydrant Locations

The “Utilities” layer contains the locations of fire hydrants. Click in the check box and expand the legend to see the hydrant symbol.



Proximity of structures to fire hydrants can be determined by using the measure tool . Click on the measure tool and then click on the symbol to measure a line. Draw line segments between the hydrant and structure, clicking at each vertex. Double-click when completed to determine the total distance.



Aerial Imagery

The bottom of the legend contains various aerial image layers. Expand the “Imagery” category in the legend to see the options. Click in the check box next to “Imagery” and in the check box next to the type of imagery to be viewed.

- Imagery
 - 2008 Photo
 - 2008 Infrared
 - 2006 Photo NAIP
 - 2004 Photo NAIP
 - USGS TOPO
 - USGS DEM



2008 Visible Image



2008 Color Infrared Image



2006 NAIP Visible Image



2004 NAIP Visible Image

Determining Elevation

In addition to aerial images, digital versions of the U.S. Geological Survey's topographic maps are also available. Click in the check box next to "USGS TOPO" under the "Imagery" category in the legend to view the 1:24,000 scale georeferenced topographic maps.

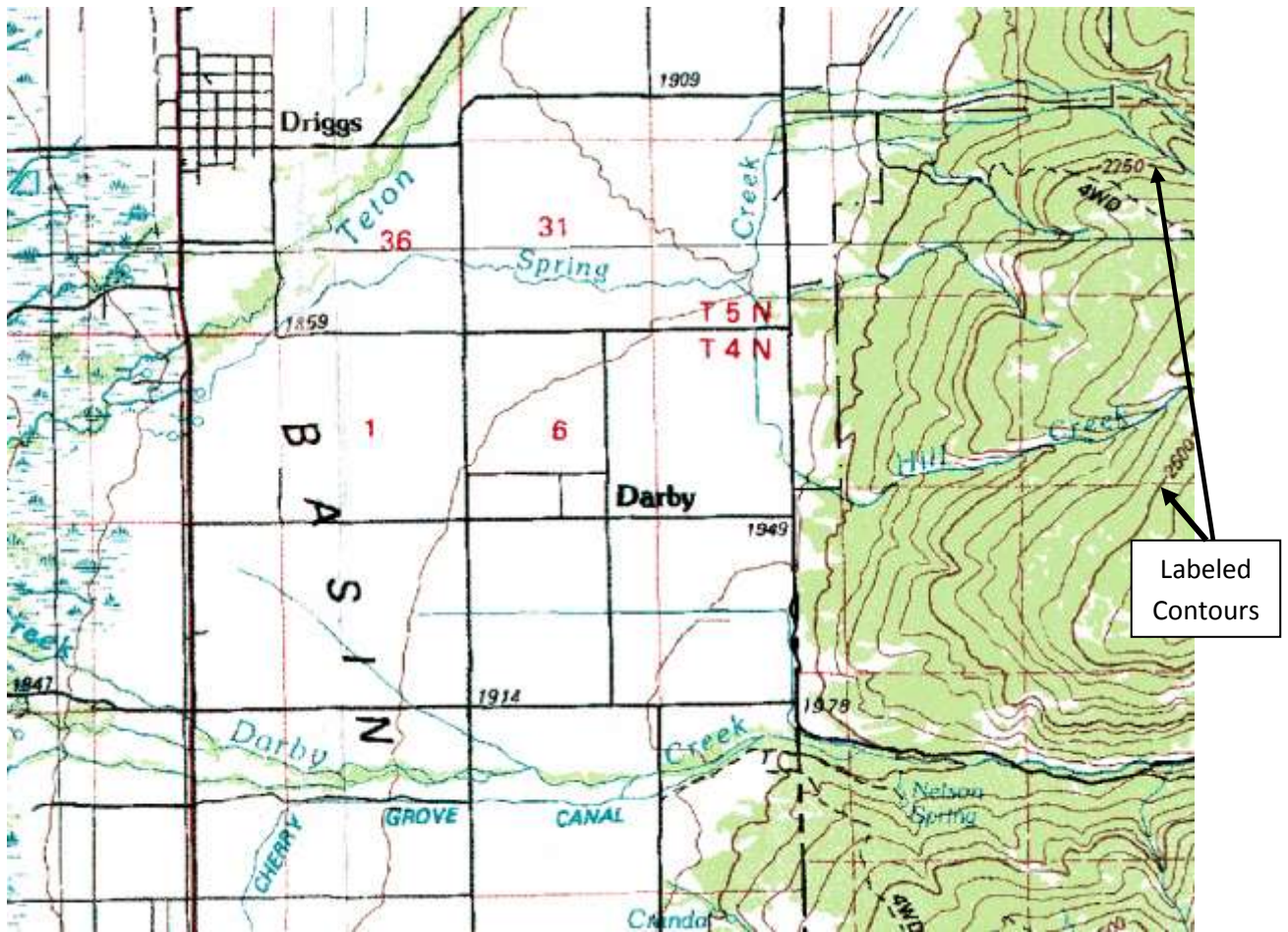

USGS topographic maps provide locations of geologic features, wetlands, rivers, streams, land boundaries, and cultural features. They can also be used to determine elevation information through contours (brown lines). The contour interval is 50 meters. Thicker contour lines are labeled and appear every five contours or 250 meters in elevation. The topographic maps can be used to estimate the elevation for a specific location. Note, elevation will be in "meters". Multiply the value obtained from the topographic map by "3.28" to determine the elevation in "feet".

The USGS also provides elevation data in the form of a grid or “raster” data set comprised of continuous cells (pixels) having horizontal (X-Y) dimensions of 10 meters x 10 meters. The Z-value of the pixel is the elevation in meters. This continuous elevation grid is called a “Digital Elevation Model” (DEM). To activate the elevation grid, click in the check box next to “USGS DEM” under the “Imagery” category in the legend. Click on the expand button to view the graduated colors and the corresponding elevations. The legend shows the elevations range from 1559 meters to 2750 meters.

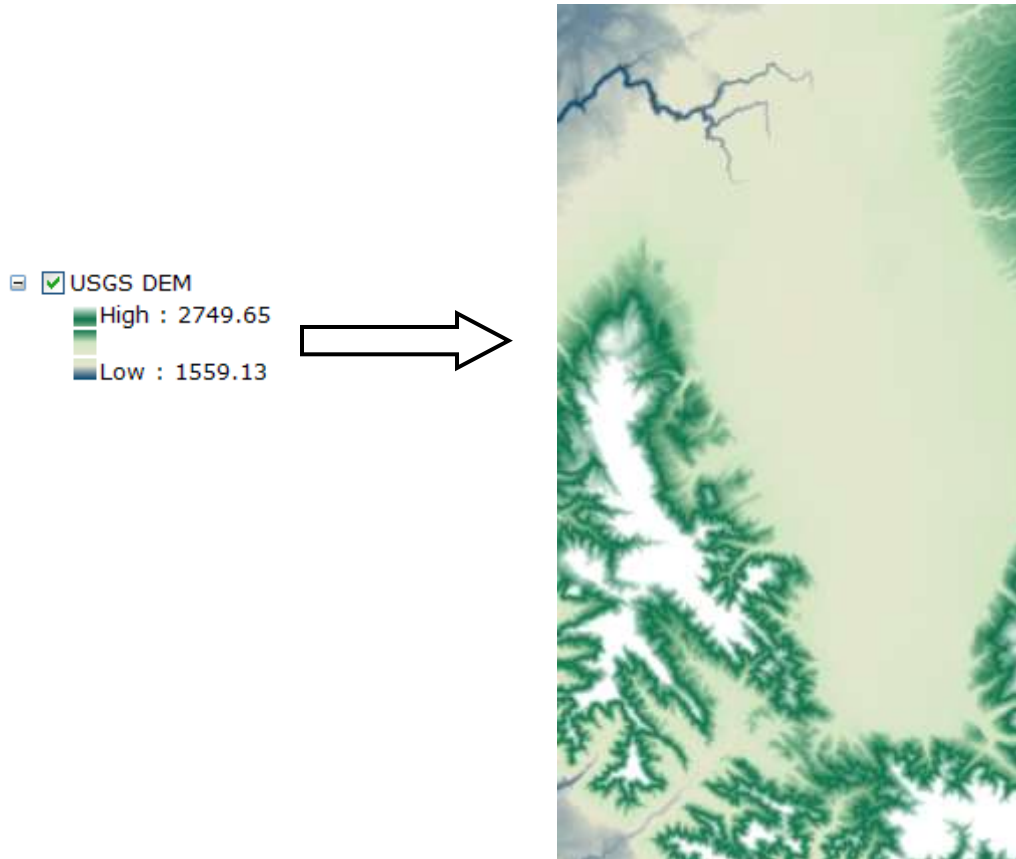

To determine the elevation for a location, zoom in to the area of interest. Click on the identify tool  and then, click on a single location. A box appears, displaying the elevation in “meters”. To convert the elevation to “feet”, multiply the value in the box by “3.28”.



Note: The identify tool identifies attributes for the top-most layer activated in the legend. Therefore, polygon layers such as parcels, legal boundaries, PLSS, public lands, other imagery, etc., must be unchecked in order for the elevation to be identified.

Printing Maps

A printable version of the map can be generated by selecting the “Print” option located on the upper left corner of the map.

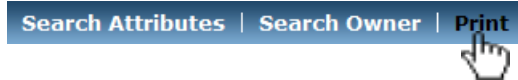

A dialog box appears. Type in the title of the map in the text box next to “Title” and choose the map size from the pull-down menu.

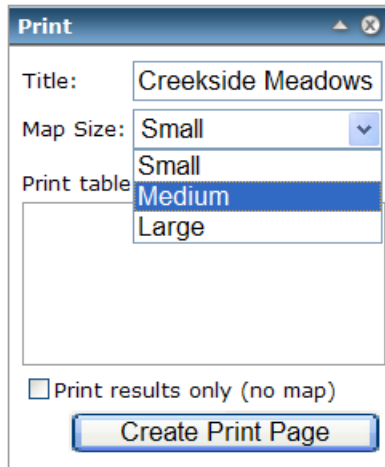

Click on the “Print” button. A pop-up window appears showing a preview of the map layout. Print the map layout using the print icon located on the pop-up window frame.



Additional Data Sources

The upper right corner of the web page contains links to plat maps, Teton County's FTP site, and available data state-wide. These links will open a new browser.

[Teton County](#) | [Download Plats](#) | [Download GIS](#) | [Idaho Clearinghouse](#) | [Region GIS](#)

Plats for Teton County:

The "Download Plats" link goes to the upper level "plats" directory. This directory is subdivided into folders for subdivisions (recorded and pending), surveys, town sites, and Federal Emergency Management Agency (FEMA) flood insurance maps. Plats are images scanned from paper surveys and end in ".TIF". Clicking on the file name will produce a dialog box prompting you to either save the file locally or open the file for viewing. Selecting the "Open" option will open the file in any software package able to view images, such as *Microsoft Office Picture Manager* or *Windows Picture and Fax Viewer*.

[Download Plats](#)

www.co.teton.id.us - /plats/

[\[To Parent Directory\]](#)

Thursday, February 05, 2009 11:51 AM	<dir> FEMA FIRM Maps
Monday, February 09, 2009 9:29 AM	<dir> Pending Subdivisions
Tuesday, September 16, 2008 11:48 AM	<dir> Recorded Subdivisions
Tuesday, December 09, 2008 2:46 PM	<dir> Surveys
Wednesday, January 02, 2008 11:22 AM	<dir> Townsites

Some of these upper level directories are further divided into subdirectories. For example, clicking on the "Townsites" link takes you to subdirectories containing the town site name. Click on the town site to view the available plats for that area.

www.co.teton.id.us - /plats/Townsites/

[\[To Parent Directory\]](#)

Monday, December 31, 2007 2:35 PM	<dir> Cache
Friday, July 18, 2008 9:02 AM	<dir> Clawson
Monday, May 19, 2008 9:21 AM	<dir> Darby
Tuesday, January 20, 2009 4:01 PM	<dir> Driggs
Wednesday, July 23, 2008 1:11 PM	<dir> Felt
Monday, December 08, 2008 1:36 PM	<dir> Haden
Monday, May 19, 2008 12:11 PM	<dir> Fratz
Monday, December 15, 2008 12:29 PM	<dir> Tetonias
Tuesday, December 16, 2008 2:45 PM	<dir> Victor

www.co.teton.id.us - /plats/Townsites/Felt/

[\[To Parent Directory\]](#)

Wednesday, December 26, 2007 3:38 PM	475266	Felt-1811.TIF
Wednesday, January 23, 2008 10:13 AM	529914	Felt-1818.TIF
Wednesday, January 23, 2008 10:13 AM	259770	Felt-1819.TIF
Wednesday, December 26, 2007 3:38 PM	351890	Felt-208-17741.TIF
Wednesday, December 26, 2007 3:38 PM	132462	Felt-208-18825.TIF
Wednesday, December 26, 2007 3:38 PM	158814	Felt-208-18752.TIF
Wednesday, December 26, 2007 3:38 PM	163642	Felt-208-18081.TIF
Wednesday, December 26, 2007 3:38 PM	126754	Felt-208-18518.TIF
Wednesday, December 26, 2007 3:38 PM	120742	Felt-212-144341.TIF
Wednesday, December 26, 2007 3:38 PM	341764	Felt-Fraction-19608.TIF
Wednesday, July 23, 2008 11:04 AM	197058	Road Variation_19211.TIF

Click on the desired .TIF image to view the plat. Generally, the file name will contain the six-digit instrument number assigned by the Clerk and Recorder's office. For historical plats, the four-digit year is included in the file name. Some file names contain "b" followed by a number. This refers to the block number where a set of parcels is located. For example, "b05" in the file name refers to "Block 5".

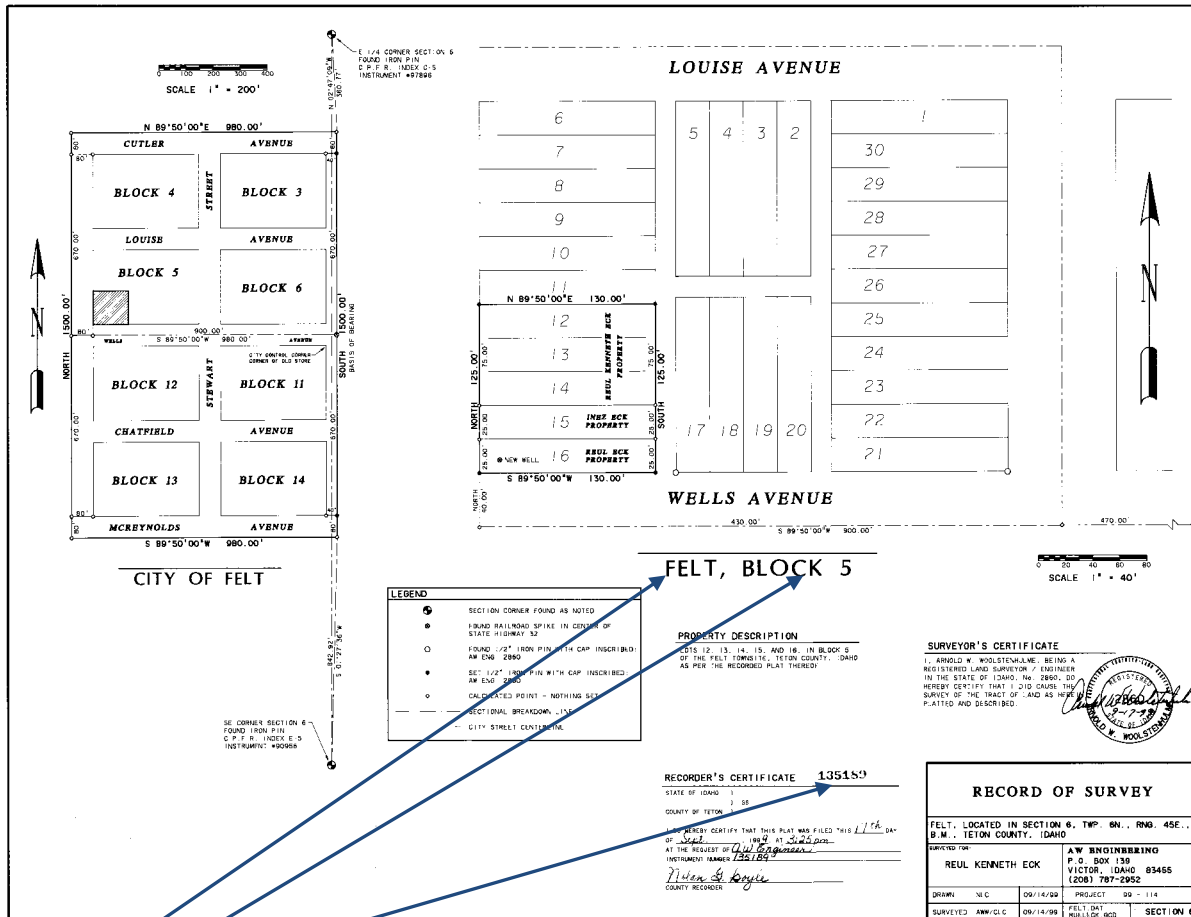

Image of "Felt-b05-135189.TIF"

Pending and recorded subdivisions are further subdivided into alphabetical directories. Plats are stored in the directory corresponding to the first letter of the subdivision name. Clicking on the link for a letter brings up links for available maps of subdivisions whose names begin with the letter selected. The "Numbered" link in "Recorded Subdivisions" or "#" link in "Pending Subdivisions" contain plats whose names begin with a number (e.g., "7 Arrows Ranch").

[To Parent Directory]			
Wednesday, March 05, 2008 2:52 PM	<dir> A		
Wednesday, October 22, 2008 12:46 PM	<dir> B		
Monday, September 08, 2008 4:23 PM	<dir> C		
Thursday, January 29, 2009 12:04 PM	<dir> D		
Thursday, December 06, 2007 9:37 AM	<dir> E		
Friday, June 13, 2008 3:52 PM	<dir> F		
Tuesday, November 04, 2008 4:57 PM	<dir> G		
Monday, December 21, 2007 2:35 PM	<dir> H		
Monday, April 07, 2008 2:47 PM	<dir> I		
Thursday, December 06, 2007 9:32 AM	<dir> J		
Wednesday, January 14, 2009 9:26 AM	<dir> K		
Tuesday, February 19, 2008 3:42 PM	<dir> L		
Thursday, August 28, 2008 12:20 PM	<dir> M		
Wednesday, July 02, 2008 1:42 PM	<dir> N		
Thursday, October 30, 2008 10:54 AM	<dir> O		
Wednesday, November 25, 2008 4:08 PM	<dir> P		
Thursday, August 14, 2008 1:50 PM	<dir> Q		
Wednesday, July 23, 2008 1:53 PM	<dir> R		
Thursday, August 24, 2008 12:15 PM	<dir> S		
Tuesday, September 16, 2008 11:49 AM	<dir> T		
Thursday, November 06, 2008 1:16 PM	<dir> U		
Tuesday, February 24, 2009 2:42 PM	<dir> V		

[To Parent Directory]			
Wednesday, November 28, 2007 3:04 PM	<dir> Haden Hollow		
Wednesday, November 28, 2007 3:04 PM	<dir> Mushlin Acres		
Wednesday, November 28, 2007 3:04 PM	<dir> Newland		
Wednesday, November 28, 2007 3:10 PM	<dir> Hansen Meadows		
Wednesday, November 28, 2007 3:11 PM	<dir> Suttons East - Country Home		
Wednesday, November 28, 2007 3:11 PM	<dir> Hatch		
Wednesday, November 28, 2007 3:11 PM	<dir> Hatch's Corner		
Wednesday, November 28, 2007 3:12 PM	<dir> Hart's		
Wednesday, November 28, 2007 3:12 PM	<dir> Hart's Edge		
Wednesday, November 28, 2007 3:12 PM	<dir> Hedges Waters		
Wednesday, November 28, 2007 3:13 PM	<dir> Hillside Meadows		
Wednesday, November 28, 2007 3:13 PM	<dir> Hollow Park Ranch		
Wednesday, November 28, 2007 3:13 PM	<dir> Hulk Hays		
Wednesday, November 28, 2007 3:13 PM	<dir> Horseshoe Creek Estates Parcel		
Wednesday, November 28, 2007 3:13 PM	<dir> Horseshoe Creek Ranch		
Wednesday, November 28, 2007 3:17 PM	<dir> Horseshoe Meadows		
Wednesday, November 28, 2007 3:18 PM	<dir> Huckle Creek Ranch		
Wednesday, December 05, 2007 3:49 PM	<dir> Hutches Springs		
Wednesday, November 28, 2007 3:25 PM	<dir> The Highlands		

Surveys for areas not included in a subdivision are available through the "Surveys" link within the "plats" directory. Surveys are grouped by the Township and Range the property resides in. The survey plats are identified by the section within the township and range, along with the instrument number provided by the Clerk and Recorder's office.

[To Parent Directory]			
Tuesday, April 14, 2009 3:07 PM	<dir> Railroad Surveys		
Wednesday, April 15, 2009 9:25 AM	<dir> T2NR44E		
Wednesday, April 22, 2009 1:27 PM	<dir> T3NR44E		
Tuesday, March 24, 2009 9:34 AM	<dir> T4NR44E		
Tuesday, April 28, 2009 11:17 AM	<dir> T4NR47E		
Tuesday, March 24, 2009 9:34 AM	<dir> T4NR48E		
Tuesday, March 24, 2009 9:35 AM	<dir> T5NR44E		
Tuesday, April 28, 2009 12:23 PM	<dir> T5NR45E		
Wednesday, October 22, 2008 12:43 PM	<dir> T6NR45E		
Monday, September 08, 2008 4:18 PM	<dir> T6NR47E		
Tuesday, April 28, 2009 9:22 AM	<dir> T6NR48E		
Tuesday, April 28, 2009 9:23 AM	<dir> T6NR49E		
Monday, December 08, 2008 2:14 PM	<dir> T6NR49E		
Thursday, January 02, 2009 11:09 AM	<dir> T7NR43E		
Tuesday, March 24, 2009 9:36 AM	<dir> T7NR44E		
Wednesday, July 23, 2008 1:14 PM	<dir> T7NR45E		

[To Parent Directory]			
Thursday, December 20, 2007 2:32 PM	1472130	Sec 20 T6NR44E 1481 T1E	
Thursday, December 20, 2007 1:46 PM	190298	sec11-138203 T1E	
Thursday, December 20, 2007 1:46 PM	450002	sec13-177949 T1E	
Thursday, December 20, 2007 1:46 PM	127082	sec14-130614 T1E	
Thursday, December 20, 2007 1:46 PM	149362	sec15-130014 T1E	
Thursday, December 20, 2007 1:46 PM	108874	sec15-135449 T1E	
Thursday, December 20, 2007 1:46 PM	195162	sec15-152369 T1E	
Thursday, December 20, 2007 1:46 PM	212074	sec15-152667 T1E	
Thursday, December 20, 2007 1:46 PM	838626	sec15-153663 T1E	
Thursday, December 20, 2007 1:46 PM	290122	sec22-128150 T1E	
Thursday, December 20, 2007 1:46 PM	244202	sec22-129054 T1E	
Thursday, December 20, 2007 1:46 PM	130626	sec22-177600 T1E	
Thursday, December 20, 2007 1:46 PM	234202	sec22-177644 T1E	
Thursday, December 20, 2007 1:46 PM	111010	sec22-177172 T1E	
Thursday, December 20, 2007 1:46 PM	148346	sec22-181803 T1E	
Thursday, December 20, 2007 1:46 PM	228722	sec22-138426 T1E	
Thursday, December 20, 2007 1:46 PM	146930	sec22-131172 T1E	

The township, range, and section for a parcel or large area can be determined using the "PLSS" in the legend. Locate the area of interest in the map. Expand the "PLSS" in the legend to show the township and section subcategories. Click in the check boxes to view the layers. Zoom out until the sections and townships come into view. The "Township" layer also contains the Range. Once the township, range, and section have been identified, the appropriate survey can be located. For those areas containing several surveys for a section, the Clerk and Recorder's office may have to be contacted to obtain the instrument number.

FEMA Flood Maps

Flood Insurance Rate Maps (FIRM) provided by the Federal Emergency Management Agency (FEMA) are available for viewing and/or download under the “plats” directory.

[www.co.teton.id.us - /plats/FEMA FIRM Maps/](http://www.co.teton.id.us/plats/FEMA_FIRM_Maps/)

[\[To Parent Directory\]](#)

Monday, January 14, 2008 11:49 AM	868898	16081C0025C.tif
Monday, January 14, 2008 11:52 AM	3694144	16081C0043C.tif
Monday, January 14, 2008 11:51 AM	1585792	16081C0050C.tif
Monday, January 14, 2008 11:51 AM	1759446	16081C0092C.tif
Monday, January 14, 2008 12:00 PM	20168646	16081C0093C.tif
Monday, January 14, 2008 11:52 AM	2100914	16081C0094C.tif
Monday, January 14, 2008 11:56 AM	5909258	16081C0100C.tif
Monday, January 14, 2008 11:56 AM	7161152	16081C0130C.tif
Monday, January 14, 2008 11:53 AM	2677510	16081C0141C.tif
Monday, January 14, 2008 11:54 AM	2825898	16081C0143C.tif
Monday, January 14, 2008 11:53 AM	1754602	16081C0144C.tif
Monday, January 14, 2008 11:54 AM	3330968	16081C0150C.tif
Monday, January 14, 2008 11:52 AM	1183738	Firm Map Index.tif

These maps are in sections or “panels”. The link labeled “Firm Map Index.tif” is a map showing the various panels. Locate the panel corresponding to the area of interest from the index map. Match the panel identifier (e.g., “16081C0150C”) with the image name in the list (e.g., “16081C0150C.tif”). Click on the link to view or download the flood map.

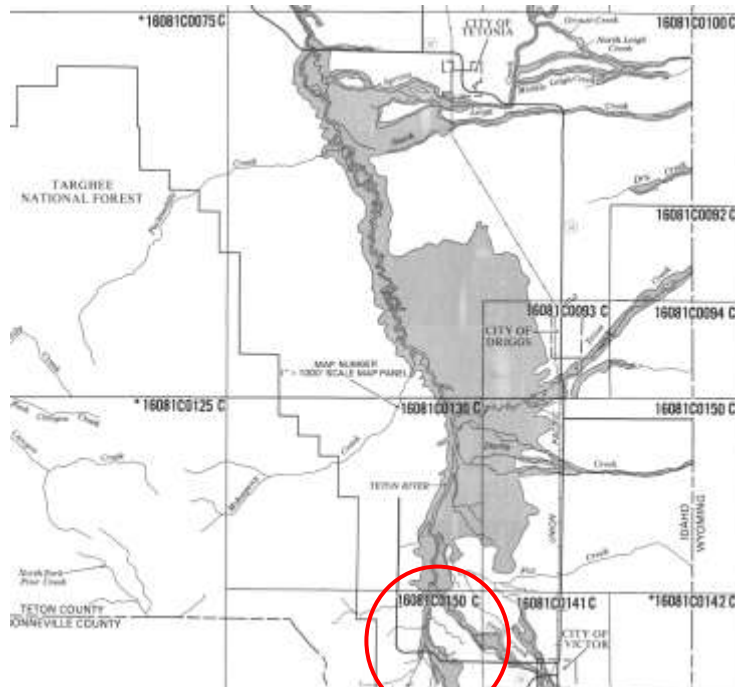

Map Index

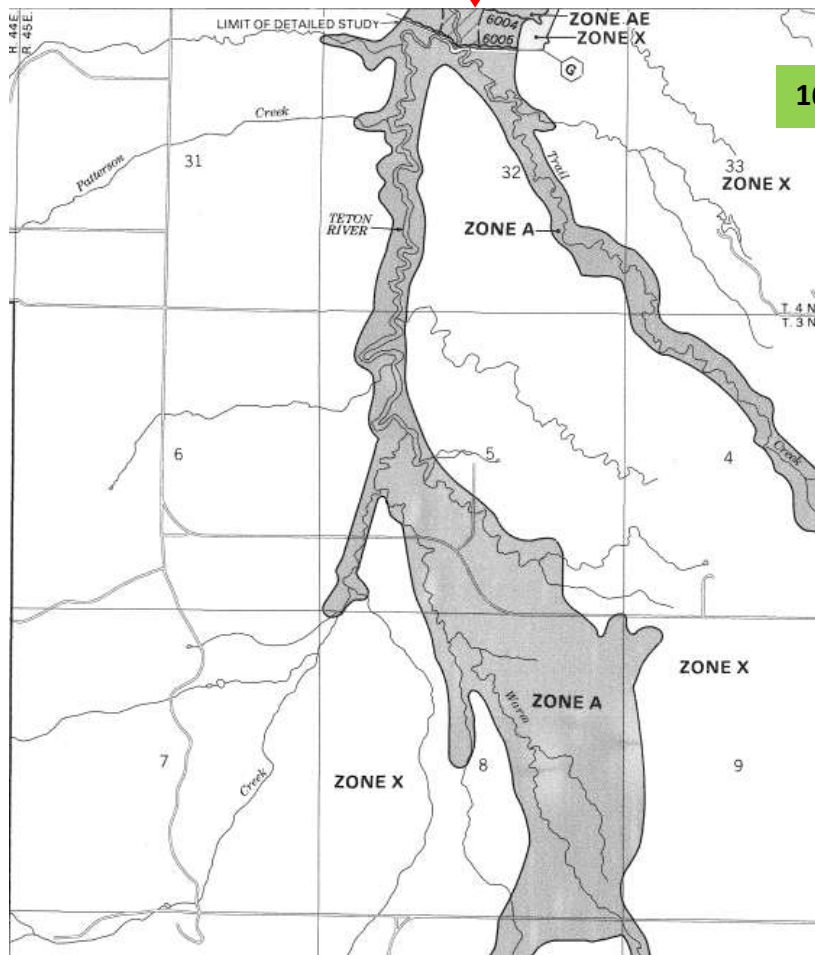

16081C0150C.tif

GIS Data Available for Download

Several data sets are available for downloading. The “Download GIS” link provides access to these data sets. The data available for downloading are parcels, addresses, roads, subdivisions, zoning, and tables from the Assessor’s database. Data are in the ESRI shapefile format and are in the “State Plane – Idaho East (NAD83)” projection.



Files are compressed in order to streamline transmission. Compressed data files contain the “.zip” extension. These data files are uploaded to the web server every night to ensure the most recent version is available.

gis.co.teton.id.us - /PublicsGIS/

[\[To Parent Directory\]](#)

Wednesday, September 02, 2009 12:09 PM	<dir> 2005
Wednesday, September 02, 2009 12:09 PM	<dir> 2007
Wednesday, September 02, 2009 12:08 PM	<dir> 2008
Wednesday, June 02, 2010 2:07 PM	<dir> 2009
Thursday, February 04, 2010 12:12 PM	403515719 2009 NAIP Aerial Imagery.zip
Monday, May 24, 2010 12:55 PM	395 Address Structural Code Description.txt
Thursday, December 30, 2010 6:22 AM	383780 address.zip
Monday, March 02, 2009 12:15 AM	125467 annexhistory.shp.xml
Monday, March 02, 2009 1:23 AM	26693 annexhistory.zip
Tuesday, October 28, 2008 3:26 PM	80956 AW Zoning.zip
Tuesday, August 26, 2008 11:44 AM	29922 commissionerdistricts.zip
Thursday, October 14, 2010 9:42 AM	<dir> Maps
Tuesday, November 10, 2009 4:24 PM	93497 Parcel Table Formats.pdf
Tuesday, November 10, 2009 4:51 PM	87320 Parcel Tables and Fields Description.pdf
Thursday, December 30, 2010 6:22 AM	4052798 parcels.zip
Thursday, December 30, 2010 6:42 AM	4932765 parceltables.zip
Tuesday, August 26, 2008 10:35 AM	26953 precincts.zip
Tuesday, April 15, 2008 6:43 AM	40164 PROPERTY CATEGORY NUMBERS.pdf
Thursday, December 30, 2010 6:22 AM	1075154 road.zip
Tuesday, September 21, 2010 10:53 AM	64 schema.ini
Thursday, December 30, 2010 6:22 AM	223095 subdivision.zip
Tuesday, June 15, 2010 10:09 AM	674239 Teton County Natrual Resource Overlay.zip
Tuesday, December 07, 2010 11:34 AM	6631564 xxparc00.dbf
Tuesday, August 26, 2008 11:52 AM	30236 zipcodes.zip
Tuesday, May 25, 2010 3:43 PM	88165 Zoning.zip

Clicking on a link with a “.zip” extension will produce a dialog box asking you to either save or open the file. If “Save” is selected, the compressed file will be saved to the local computer. If “Open” is selected, a program is executed that will uncompress the .zip file. This can be *WinZip*

or some other package that is able to uncompress .zip files. The shapefiles can then be extracted and stored on the local computer.

There are also links to archived data that go back to 2007. These are broken down further into subdirectories labeled by day and month.

GIS Data for the State of Idaho

Data sets provided by various counties and municipalities throughout the state of Idaho can be obtained from the “Idaho Clearinghouse” link. This link connects to the Interactive Numeric & Spatial Information Data Engine (INSIDE) Idaho web site. There are various links to view and download GIS data sets, including data from Teton County.

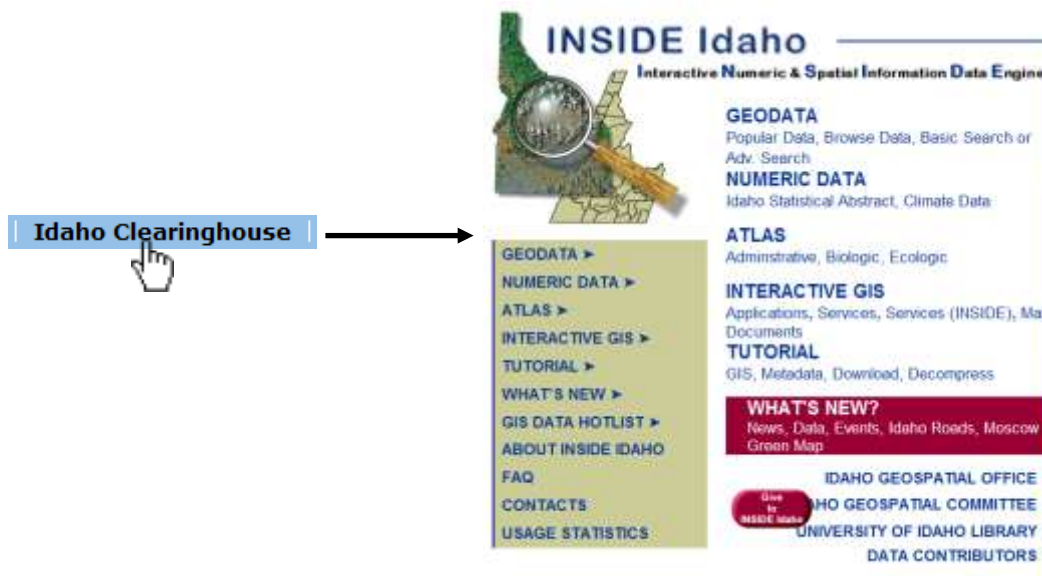

Resource Links

Two links in the upper right corner of the web page provide additional information. The “Teton County” link takes you to the Teton County home page. The “Region GIS” link is connected to the “East Idaho Regional GIS” and provides information about regional efforts to improve GIS data quality and services throughout eastern Idaho.